

Name: Class:

Identify open and closed shapes

Are the following shapes open or closed? Tick the correct answer.

a.

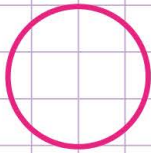

a. Closed b. Open

e.



a. Closed b. Open

b.

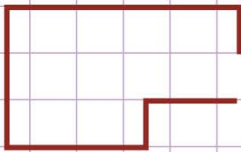

a. Open b. Closed

f.

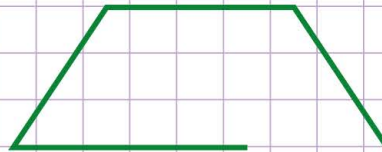

a. Open b. Closed

c.



a. Closed b. Open

g.

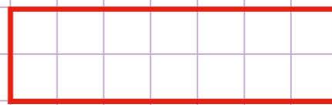

a. Closed b. Open

d.

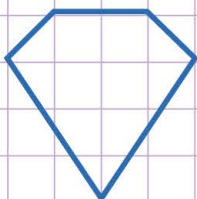

a. Closed b. Open

h.

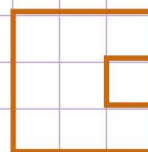

a. Open b. Closed



Name: Class:

Identify open and closed shapes

Are the following shapes open or closed? Tick the correct answer.

a.

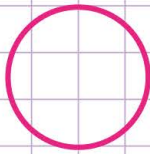

a. Closed b. Open

e.

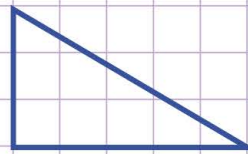

a. Closed b. Open

b.

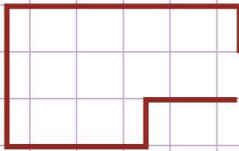

a. Open b. Closed

f.



a. Open b. Closed

c.



a. Closed b. Open

g.

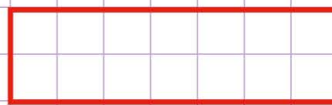

a. Closed b. Open

d.

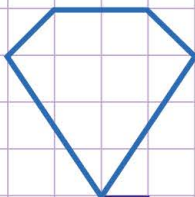

a. Closed b. Open

h.

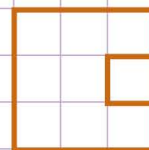

a. Open b. Closed

